

alfi — Flick —

MODEL : Flick-N°1, Flick-N°2

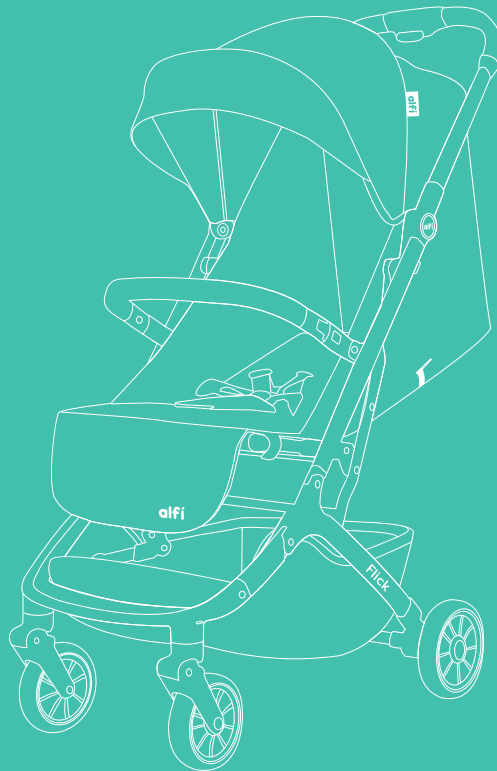

Line : @alfibaby

สแกนเพื่อดู
วิดีโอการติดตั้ง



IMPORTANT : PLEASE KEEP INSTRUCTIONS FOR FUTURE REFERENCE.

IMPORTANT: Please read these instructions carefully before use and save for future reference.

- **WARNING** NEVER LEAVE THE CHILD UNATTENDED
- **WARNING** ENSURE THAT ALL THE LOCKING DEVICES ARE ENGAGED BEFORE USE.
- **WARNING** TO AVOID INJURY ENSURE THAT THE CHILD IS KEPT AWAY WHEN FOLDING AND UNFOLDING THIS PRODUCT
- **WARNING** DO NOT LET THE CHILD PLAY WITH THIS PRODUCT
- **WARNING** ALWAYS USE THE HARNESS RESTRAINT SYSTEM
- **WARNING** THIS PRODUCT IS NOT SUITABLE FOR RUNNING OR SKATING
- **WARNING** ALWAYS APPLY THE BRAKE WHENEVER THE STROLLER IS STATIONARY.
- **WARNING** DO NOT CARRY EXTRA CHILDREN OR BAGS IN THIS STROLLER
- **WARNING** ALWAYS USE THE CROTCH STRAP OF THE HARNESS IN COMBINATION WITH THE WAIST AND SHOULDER BELT.
- **WARNING** WHEN NOT IN USE DISCONNECT SHOULDER STRAPS FROM THE WAIST STRAP AND/OR BUCKLE.
- **WARNING** MAKE SURE CHILDREN ARE KEPT CLEAR OF ANY MOVING PARTS IF YOU ADJUST THE STROLLER.
- **WARNING** THE MAXIMUM AUTHORIZED LOAD FOR THE SHOPPING BASKET IS 2KGS.

- **WARNING** THE CHILD MUST BE SECURED BY THE 5-POINT SAFETY HARNESS AT ALL TIMES
- **WARNING** HANGING ITEMS OR LOADS ON THE HANDLE BAR MAY IMPAIR THE STROLLER'S STABILITY.
- **WARNING** BEFORE ASCENDING OR DESCENDING ESCALATORS OR STAIRS, ALWAYS REMOVE CHILD AND FOLD THE STROLLER.
- **WARNING** KEEP THE STROLLER AWAY FROM OPEN FIRE, EXPOSED FLAME HEATERS AND OTHER SOURCES OF STRONG HEAT
- **WARNING** IT IS RECOMMENDED TO PERIODICALLY CLEAN ALL MOVING PARTS IN ORDER TO MAINTAIN PROPER FUNCTION OF THE STROLLER.
- **WARNING** IT IS RECOMMENDED TO REGULARLY TEST AND CHECK THAT THE LOCKING MECHANISM IS FUNCTIONING PROPERLY AND HAS NOT BEEN DAMAGED PRIOR TO USAGE.
- **WARNING** ENSURE THE BRAKE IS ENGAGED BEFORE PLACING YOUR BABY IN AND OR REMOVING YOUR BABY FROM THE STROLLER.
- **WARNING** ONLY USE THIS STROLLER TO TRANSPORT ONE CHILD AT A TIME.

CARE AND MAINTENANCE

- Always use a non-toxic, non-abrasive cleaning agent or solvent to clean your stroller.
- It is recommended to use a water solution with a small amount of non-toxic detergent (preferably soap) to clean the stroller with a clean, damp cloth.
- The fabric parts may be removed and machine washed. (Max. Temp: 30°C)
Do not use strong detergents or bleach.
- If you need to put your stroller in storage for any period of time, ensure storage area is well ventilated at all times and avoid storing in a damp, hot and or humid environment.
- Always use the rain cover when raining.
- If stroller does get wet, ensure it is thoroughly dry again before folding and storing it.

Unfolding

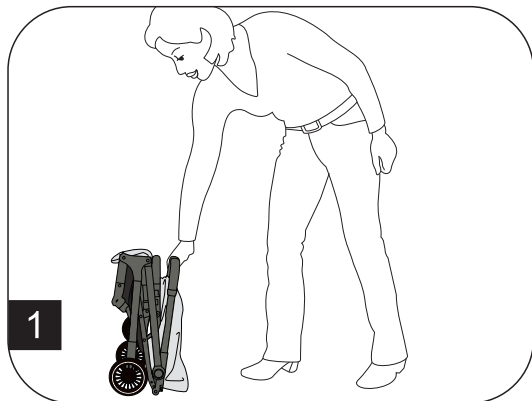

1. Open the folding lock (as shown in [1] and [2])
2. Lift the handlebar, then unfold the stroller (as shown in [3] and [4])

Folding

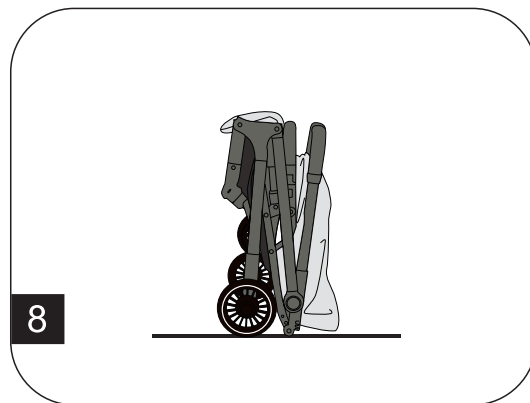
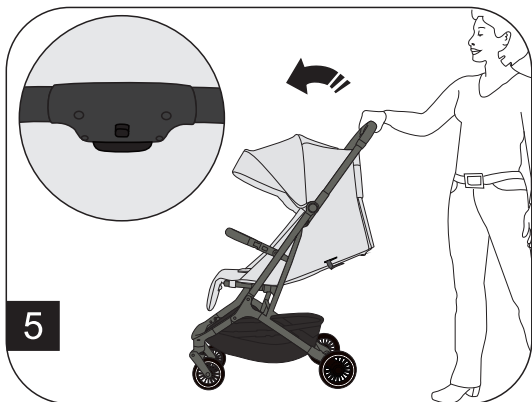

1. Press the two keys simultaneously (as shown in [5])
2. Push the stroller down until there is a 'click' sound (as shown in [6] and [7])

6

Back Seat Adjustment

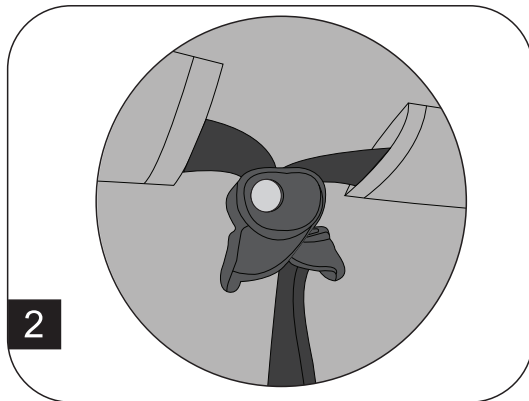

Leg Rest Adjustment

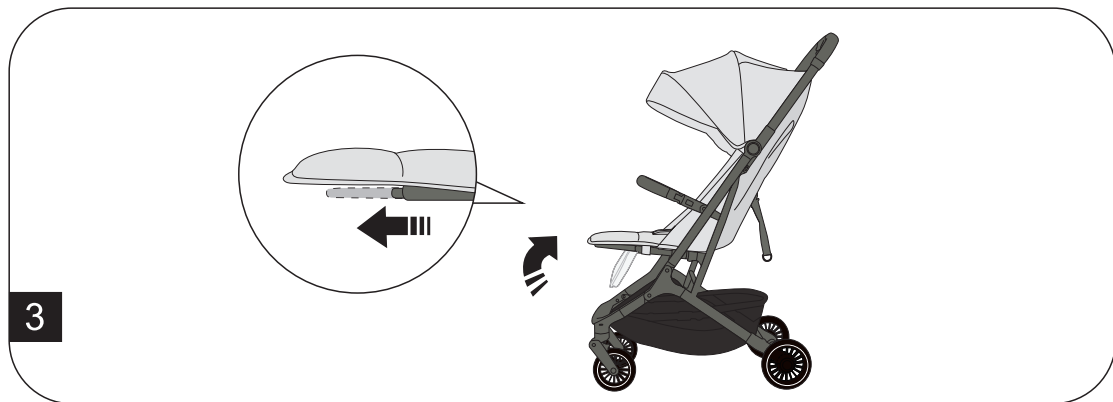

1. The seat's backrest can be adjusted from upright position to reclined position and vice versa by adjusting the buckle (as shown in [1])
2. The leg rest can be adjusted by sliding the handlebar in a forward and backward motion (as shown in [3])

Fasten & Loosen Seat Belt

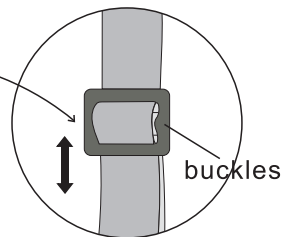
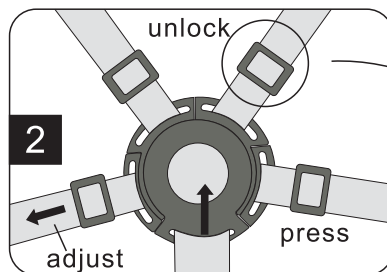
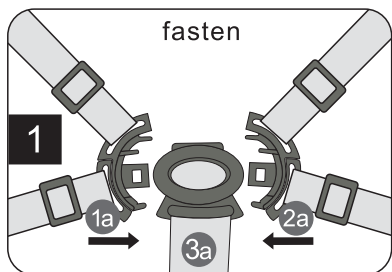

1. Buckle 1a and 2a are clasped into 3a, then fastened or loosened the seat belt (as shown in [1])
2. Press the middle button to disengaged the seat belt (as shown in [2])
3. Belt adjustment; pull one end of the safety belt then slide the buckles up or down to adjust the length (as shown in [2])
4. The shoulder strap has 3 positions which it can be adjusted to (as shown in [3])
5. Take out the waist strap and shoulder strap from the hole in the backrest, then insert it into your desired position.
6. Insert the bumper bar into the joint (as shown in [4])
7. To remove the bumper bar, press the button on the side and slide the bumper bar out (as shown in [4])

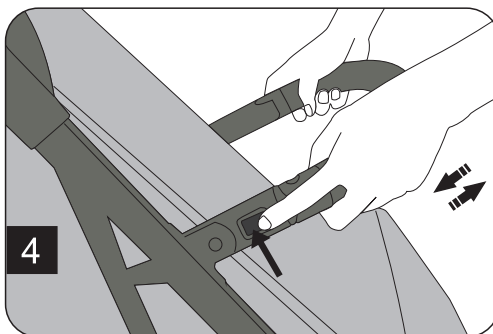
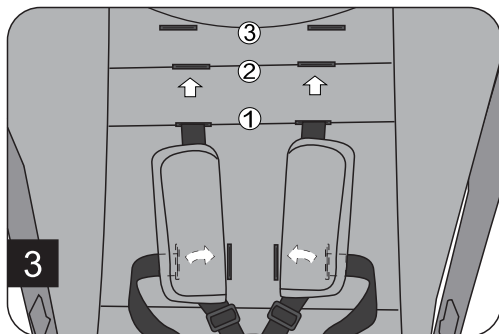

How To Assemble The Front Wheels and Rear Wheels

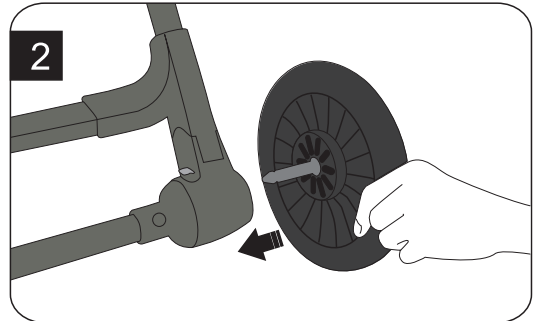
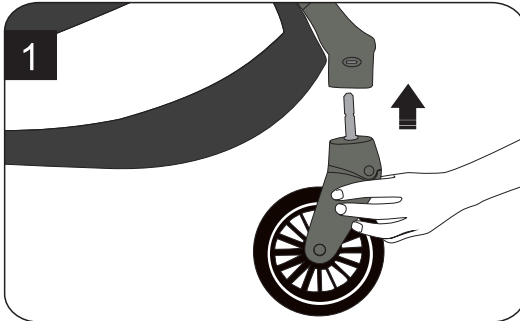

WARNING: Before use, ensure that the wheel units are safely locked into position.

1. Fit the front wheel unit into its designated slot and lock it into position until there is a 'click' sound (as shown in [1]) – Repeat this step on the other side.
2. Fit the rear wheel unit into its designated slot and lock it into position until there is a 'click' sound (as shown in [2]) – Repeat this step on the other side.

On/Off Brake Position

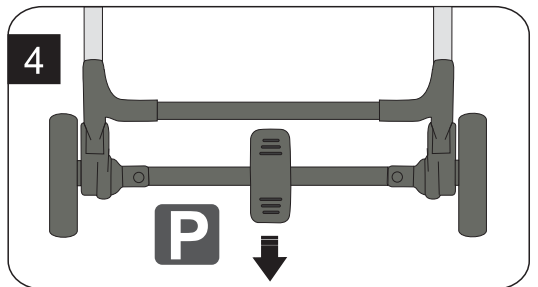
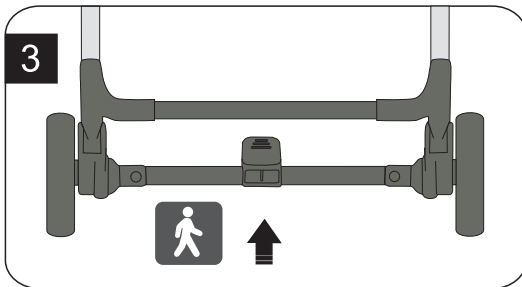

3. Step on the pedal in forward position to unlock the brake (as shown in [3])
4. Step on the pedal in backward position to engage the brake (as shown in [4])

