

# alfi

## Product Instruction

Product Model SKU : CS\_AL-09

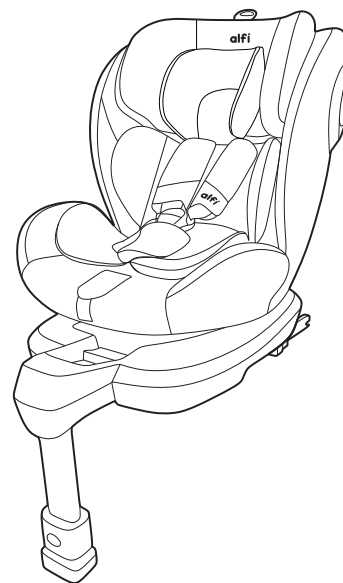

### COSCO-9

Group: 0 + / 1 / 2 / 3 (0–36kg) Rotate 360 degrees

This child restraint is approved to GB 27887-2011 and UN ECE regulation 44, 04 series of amendments. Please read all the instructions in this manual before installing and using the product.

# Contents

1 Seat Composition - - - - -	01
2 Warning - - - - -	02
3 Product Information - - - - -	04
4 Concerns on Installation - - - - -	06
5 Installing the Base - - - - -	07
6 Recline Adjustment - - - - -	07
7 Choose the Installation Mode - - - - -	10
7 Height Adjustment Headrest and Shoulder Harnesses - - - - -	11
8 Group 0+ Model 1 - - - - -	12
9 Group 0+ Model 2 - - - - -	14
10 Group I Model 1 - - - - -	18
11 Group I Model 2 - - - - -	20
12 Group II III Model 1 - - - - -	24
13 Group II III Model 2 - - - - -	26
14 Detach Clothes Cover - - - - -	27
15 Maintenance - - - - -	28

# Seat Composition

- |                              |                                  |
|------------------------------|----------------------------------|
| 1 Head Support               | 9 Rotating Button                |
| 2 Seat Pad                   | 10 Shoulder Strap                |
| 3 Buckle                     | 11 Head Support Adjustment Lever |
| 4 Adjustment Webbing         | 12 FIX Guides Connector          |
| 5 Recline Adjustment Button  | 13 FIX Adjuster Button           |
| 6 Load Leg                   | 14 FIX Guides                    |
| 7 Load Leg Indicator         |                                  |
| 8 Load Leg Adjustment Button |                                  |

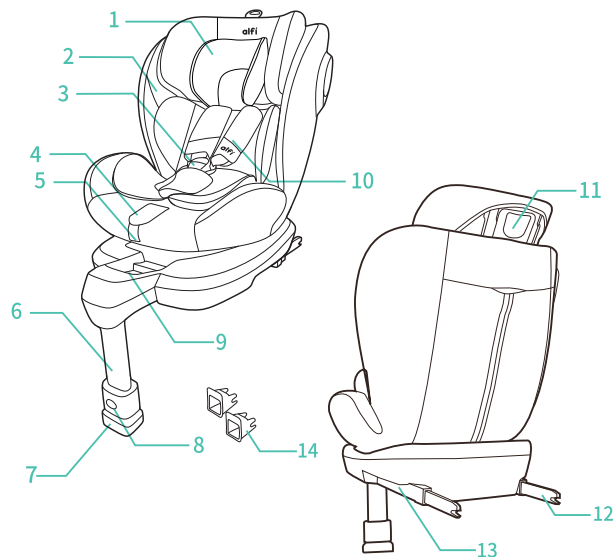

## WARNING

! DO NOT have your child in swaddled clothes when using this child restraint in rear facing or forward facing mode, because this may prevent your child from being properly and securely fastened by the shoulder harnesses and the harnesses between thighs.

! DO NOT leave this child restraint unsecured in your vehicle because an unsecured child restraint can be thrown around and may injure occupants in a sharp - turn, sudden stop, or collision. Remove it if not in regular use.

! NEVER install this child restraint on any vehicle seat equipped with safety airbags when used in rear facing mode.

! NEVER use a second-hand child restraint or a child restraint whose history you do not know because they may have structural damage that endangers your child's safety.

! DO NOT use this child restraint as a regular chair as it tends to fall down and could injure the child.

! DO NOT put anything other than the recommended soft goods in this child restraint.

! DO NOT carry this child restraint with a child in it.

## WARNING

! Do not allow the child restraint harness or buckles to become trapped or caught in the vehicle seat or door.

! To avoid suffocation, remove plastic bag and packaging materials before using this product. The plastic bag and packaging materials should then be kept away from babies and children.

! Do not place any objects in the load leg area in front of your base.

! Frequently check the FIX guides for dirt and clean them if necessary. Reliability can be effected by ingress of dirt, dust, food particles etc.

! Remove this child restraint from the vehicle seat when it is not in use for a long period of time.

! Consult the retailer for issues concerning maintenance, repair and part replacement.

! DO NOT install this child restraint under the following conditions:

1. Vehicle seats with lap belt or 3-point-belt.
2. Vehicle seats facing sideways or rearward with respect to the running direction of the vehicle.
3. Vehicle seats movable during installation.

# Emergency

In case of emergency or accidents, it is most important to have your child taken care of with first aid and medical treatment immediately.

## Product Information

Notice regarding universal category (Group 0+ I II II)



1. This is a "Universal" child restraint. It is approved to Regulation No.44,04 series of amendments. For general use in vehicles and it will fit most, but not all, car seats.
2. A correct fit is likely if the vehicle manufacture has declared in the vehicle handbook that the vehicle is capable of accepting a "Universal" child restraint for this age group.
3. This child restraint has been classified as "Universal" under more stringent conditions than those which applied to earlier designs which do not carry this notice.
4. If in doubt, consult either the child restraint manufacture or the retailer.

Notice regarding semi-universal category (Group 0+ I II II)



This child restraint is classified for "(~~Restricted~~ / Semi-universal)" use and is Suitable for fixing into the seat positions of the following cars:

CAR	FRONT	REAR
Refer to	Outer	Center
Vehicle lise	Yes	<del>Yes</del> No

Seat position in other cars may also be suitable to accept this child restraint. If in doubt, consult either the child restraint manufacture or the retailer.

Group 0+	0-13kg	0-13kg	3-point safety belts+harness
Group 0+	0-13kg	0-13kg	3-point safety belts+harness+FIX+Support leg
Group I	9-18kg	9-18kg	3-point safety belts+harness
Group I	9-18kg	9-18kg	3-point safety belts+harness+FIX+Support leg
Group II+III	15-36kg	15-36kg	3-point safety belts
Group II+III	15-36kg	15-36kg	3-point safety belts+FIX

Product: Child restraint

Suitable for: Child weighing 36kg (approximately 12 years old under)

Mass Group: 0+I/II/III

Materials: Plastics, metal, fabrics

Read all the instructions in this manual before using the product.

## Safety Precautions for Installation

see images 1 - 2

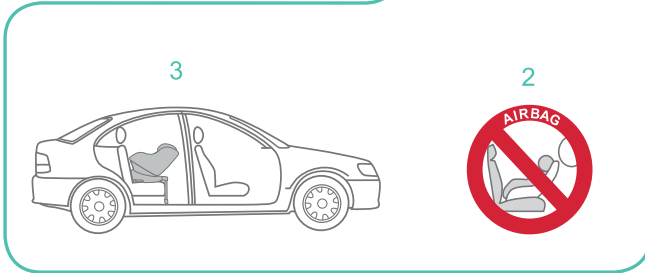
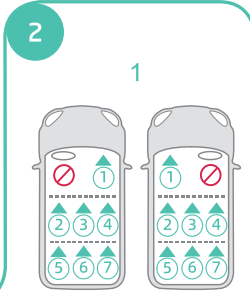
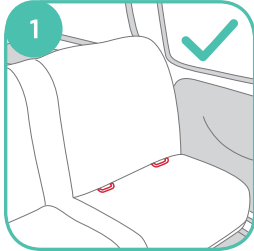

## Choose the Installation Mode

Child Weight	Installation Mode	Installation	Reference Age	Binding Mode
0-13kg	Rear facing mode		Approx birth to 1,5 years	ISOFIX+Support leg +harness
9-18kg	Forward facing mode		Approx 1 year to 4 years	ISOFIX+Support leg +harness
15-25kg 25-36kg	Forward facing mode		Approx 4 years to 12 years	1. 3-point safety belts 2. 3-point safety belts +FIX

## Installing the Base

see images 3 - 12

1. After placing the base on the vehicle seat, pull the load leg downward to floor.(Fig.3)

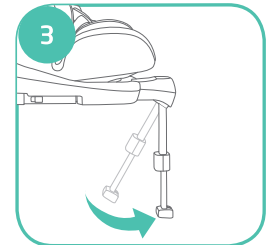

2. Insert FIX guides to assist with installation.(Fig.4.1)

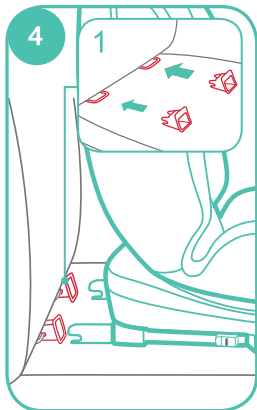

3. Press the FIX adjuster button to extend the FIX. (Fig.5)

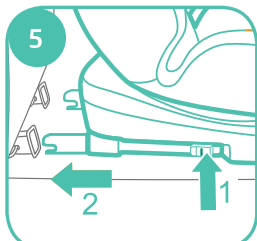

4. Make sure that both FIX connectors are securely attached to their FIX anchor points. (Fig.6)

! Make sure that both ISOFIX connectors are securely attached to their FIX anchor points. The colors of the indicators on the both FIX connectors should be completely green.(Fig.6.1)

! Check to make sure the base is securely installed by pulling on the both FIX connectors.

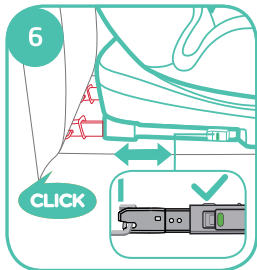

5. After attaching the ISOFIX, pull the load leg downward to floor. When the load leg(Fig.7) indicator shows green, the load leg is installed correctly.(Fig.8)

! The load leg has 14 positions. When the load leg indicator shows red this means the load leg is in the wrong position.

! Make sure the load leg is in full contact with the vehicle floor pan. Red means it is installed incorrectly.

! Squeeze the load leg releasing button, then adjust the load leg length.

6. The completely assembled base is shown as the FIX connectors must be attached and locked onto the FIX anchor points. (Fig.9.1)

! The load leg must be installed correctly with green indicator. (Fig.9.2)

7. Please refer to rear facing mode and recline positions mode insetion to use the child restraint.

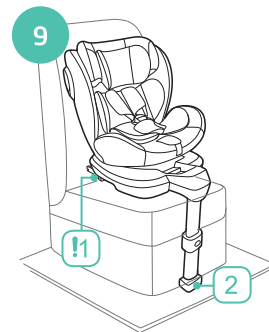
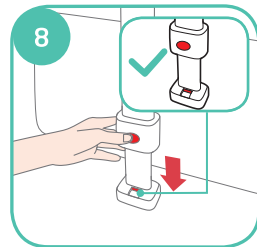
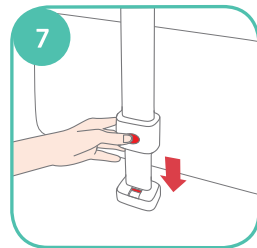

8. To remove from the vehicle press the FIX adjuster button (Fig.10.1) and pull the base back from the seat. (Fig.10.2)

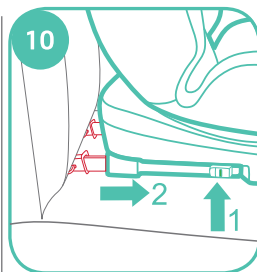

9. Press the second lock and release button on both FIX connectors and pull the base outward. (Fig.11)

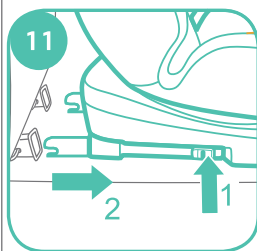

## Recline Adjustment

see images 13 - 14

Squeeze the recline adjustment-button (Fig.13), to adjust the child restraint to the proper position. The recline angles are shown as (Fig.14).

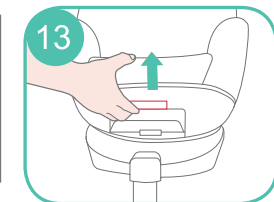

! Please recheck the load leg position after reclining.

There are recline positions for rearfacing mode and 4 recline positions for forward facing mode. (Fig.14)

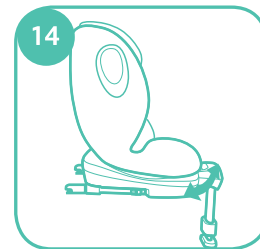

## Height Adjustment for Head Support and Shoulder Harnesses

see images 15 - 17

1. Please adjust the head support and check if the shoulder harnesses are at the correct height according to (Fig.15)

! When used rear facing and forward facing, the shoulder harness height must be even with or just above the child shoulders. (Fig.15)



2. Pull the headrest up by the adjust handle (Fig.16.1) meanwhile pull up or push down on the head support until it snaps into one of the 10 positions. The head support positions are shown as (Fig.17).

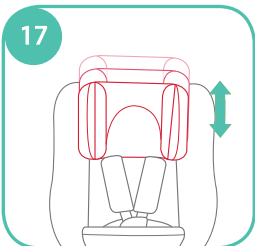
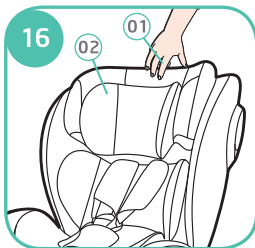

**Using in the Rear Facing Mode(Rearward Facing Mode/for Child under 13kg/infant-1.5 years old)**  
**Reference age: Newborn-1.5 years old**

Group 0+  
 3-point safety belts+harness

Pull the 3 - point safety belt up to the maximum

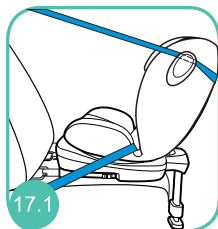

Through the bottom of the seat, and fasten the 3 - point safety belt to the maximum

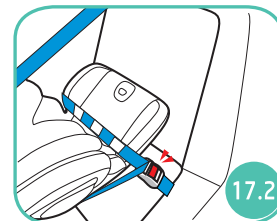

Pass the seat belt attachment through the seat belt guide slots on both sides of the seat and fasten the buckle

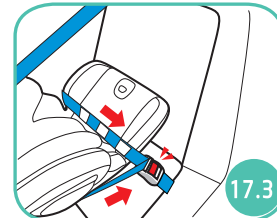

Pass the shoulder strap of the 3-point safety belt through the seat belt guide hook on the side of the seat

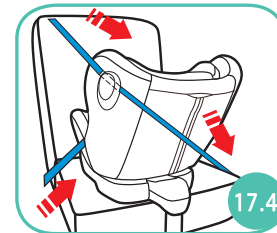

### Securing Child

After the child is placed into the seat, check whether the Shoulder Harness Straps are at proper height. SEE (Fig.23-Fig.27)

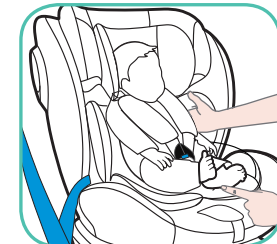



Group 0+  
3-point safety belts+FIX+Support leg+harness

see images 3 - 9

! Please install the child restraint on the rear vehicle seat and then put the child in the child restraint.

see images 18 - 27

1. Press the FIX adjuster button (Fig.18.1) and pull the base back from the vehicle seat. (Fig.18.2)

2. Press the rotating button to rotate for easier side loading/un-loading of the child, then rotate back to desired direction. (Fig.19)(Fig.21)

3. If a tighter install or increased cabin space is required, then press the FIX adjuster button (Fig.20.1) and push to adjust (Fig.20.2)

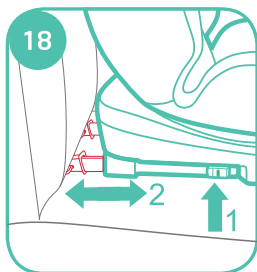
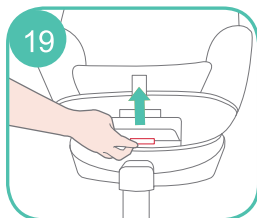
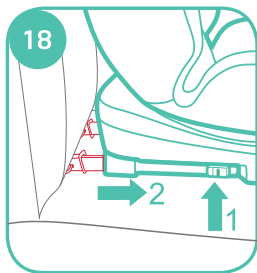

4. Install the child restraint in the rear facing mode as (Fig.21)

! The FIX connectors must be attached and locked onto the FIX anchor points. (Fig.21.1)

! The load leg must be installed correctly with green indicator. (Fig.21.2)

5. Binding the baby car seat with 3-Point safety belt in the way like Mode 1, see (Fig.17.1-Fig.17.4)

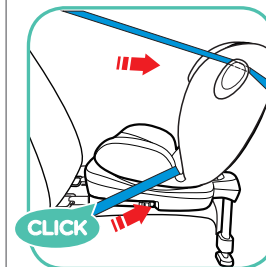
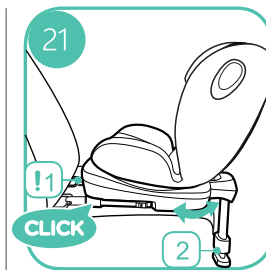

### Securing Child

After the child is placed into the seat, check whether the Shoulder Harness Straps are at proper height.

1. Press the webbing adjustment button, while pulling out the shoulder harnesses to the proper length. (Fig.22)

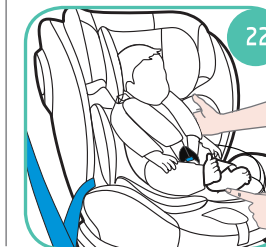



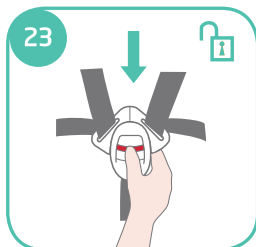

2. Unlock the buckle of the harnesses by pressing the red button. (Fig. 23)

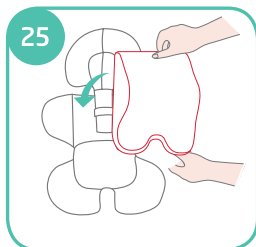
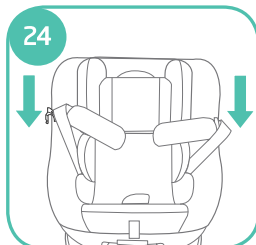

3. Open the safety buckle and place the seat belt on both sides of the seat into the child. (Fig. 24)

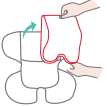

 <p>We recommend using the full cushion while the baby is 0-6 months or until they out grow the insert. The cushion increases side impact protection.</p>	 <p>Detach the snaps on the head support to remove the head portion of the cushion.</p>	 <p>Remove the head support portion of the cushion when the child head no longer sits comfortably.</p>
	 <p>Remove the cushion by detaching the snaps to allow more space when the infant does not sit comfortably. The cushion can be used separately without being attached to the insert to bolster the infant's back for more comfort.</p>	 <p>1</p>

5. Place the child into the child restraint and pass both arms through the harnesses.

! After the child is seated, recheck whether the shoulder harnesses are at the proper height.

6. Engage the buckle. Please refer to (Fig. 26)

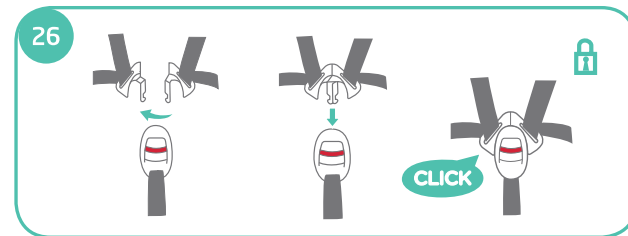

7. Pull down the adjustment webbing and adjust it to the proper length to make sure your child is properly secured. (Fig. 27)

! Make sure the space between the child and the Shoulder Harness Straps is about the thickness of one hand.

8. If steps (Fig. 22)(Fig. 23)(Fig. 24) are taken when arriving at your destination whilst removing the child then the harness will be positioned so that it is out of the way and ready for loading upon your return to the vehicle.



**Using in the Forward Facing Mode(Forward Facing Mode/for Child between 9 -18kg/1 -4 years old)**  
**Reference age:1 -4 years old**

Group I  
3-point safety belts+harness

Pull the 3 - point safety belt up to the maximum



Through the bottom of the seat and fasten the 3 - point safety belt to the maximum, see (Fig.27.4)

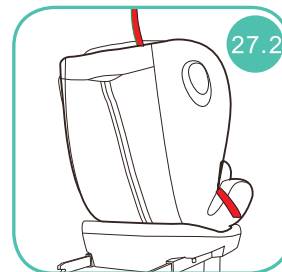

Fasten the buckle, see (Fig.27.3)



Tighten up 3-Point safety belt see (Fig.27.4)

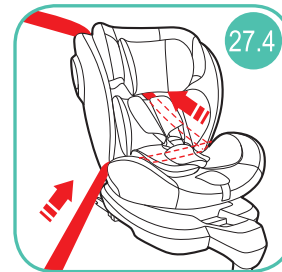

### Securing Child

After the child is placed into the seat, check whether the Shoulder Harness Straps are at proper height. SEE (Fig.23-Fig.27)

Group I  
3-point safety belts+FIX+Support leg+harness

see images 3 - 9

! Please install the child restraint on the rear vehicle seat and then put the child in the child restraint.

see images 28 - 35

1. Press the FIX adjuster button (Fig.28.1) and pull the base back from the vehicle seat. (Fig.28.2)

2. Press the rotating button to rotate for easier side loading/unloading of the child, then rotate back to desired direction (Fig. 29)(Fig.31)

3. If a tighter install or increased cabin space is required, then press the FIX adjuster button (Fig.30.1) and push to adjust (Fig.30.2)

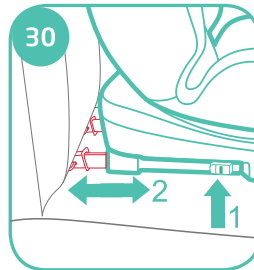
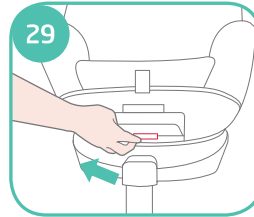
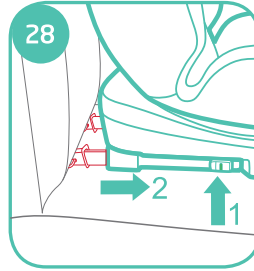

4. Install the child restraint in the forward facing mode as (Fig.31)

! The FIX connectors must be attached and locked onto the FIX anchor points. (Fig.31.1)

! The load leg must be installed correctly with green indicator.(Fig. 31.2)

5. Binding the baby car seat with 3-Point safety belt in the way like Mode 1, see (Fig.27.1-Fig.27.4)

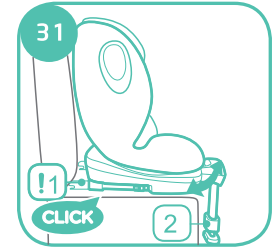

### Securing Child

After the child is placed into the seat, check whether the Shoulder Harness Straps are at proper height. SEE (Fig.32-Fig.35)

## Securing Child

After the child is placed into the seat, check whether the Shoulder Harness Straps are at proper height.

1. Press the webbing adjustment button, while pulling out the shoulder harnesses to the proper length. (Fig.32)

2. Unlock the buckle of the harnesses by pressing the red button. (Fig. 33)

3. Fix the buckles on the both sides of seat to make placing the child in forward facing mode more convenient.(Fig. 34)

! When installing the child restraint in the forward facing mode, do not use the cushion.

4. Place the child into the child restraint and pass both arms through the harnesses.

! When used rear facing and forward facing, the shoulder harness height must be between with or just above the child shoulders. (Fig. 15)

! After the child is seated, recheck-whether the shoulder harnesses are at the proper height.

5. Engage the buckle. (Fig.26)

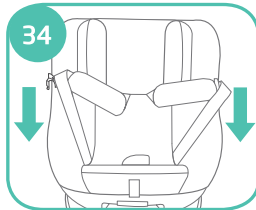
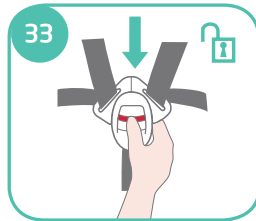
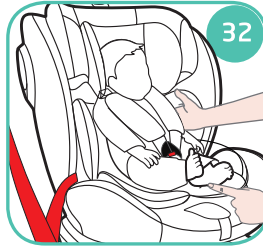

6. Pull down the adjustment webbing and adjust it to the proper length to make sure your child is properly secured. (Fig. 35)

! Make sure the space between the child and the Shoulder Harness Straps is about the thickness of one hand.

7. If steps (Fig. 32)(Fig. 33)(Fig. 34) are taken when arriving at your destination whilst removing the child, then the harness will be positioned so that it is out of the way and ready for loading upon your return to the vehicle.

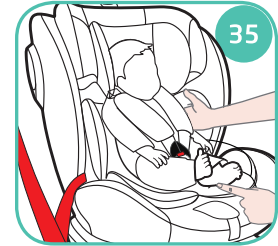

**Using in the Forward Facing Mode (Forward Facing Mode/for Child between 15-25kg / 22-36kg)**  
**Reference age: 3-12 years old**  
**Recline position: Position 1-4**

Group II III

**3-point safety belts+FIX**

! Please install the child safety seat into the car seat before allowing children to ride.

! When clamping the child safety seat, adjust the base to the fourth stage.

! FOR Child between needs to be fixed with the car seat belt. The small seat cushion should be removed. Crotch sheath and shoulder strap sheath, and keep the shoulder strap and safety buckle well hidden.

36 37 38 39 40

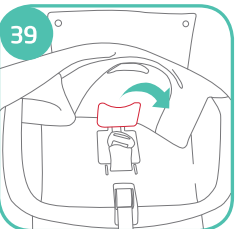
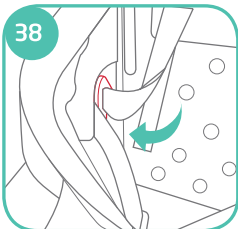
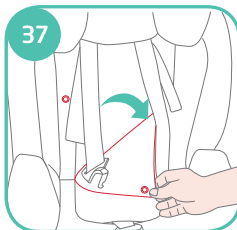
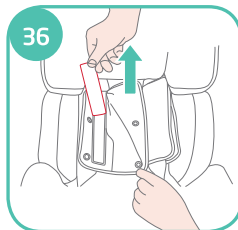

! Adjust the straps to an appropriate length before storing the straps and safety.

! Pass the shoulder strap through the shoulder guide, the belt through the seat slot, and then insert the seat belt buckle into the buckle and tighten the seat belt. 41

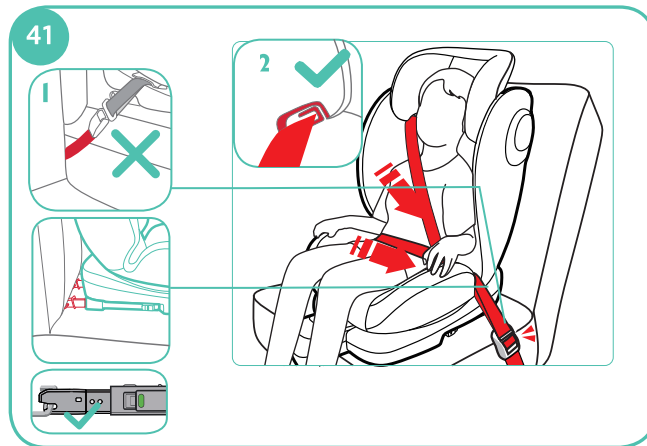

! When used in child mode, the position of the car shoulder strap guide should be the same as or slightly higher than the child's shoulder. 42

! If the car seat belt buckle is too long, the car seat belt cannot be fastened and cannot be used. 41 -1

! The car strap must pass through the car strap guide. 41 -2

! Make sure that both the left and right connectors are fixed to the ISOFIX fixed point and that the indicators on both connectors display green. 41 -3

! Do not let the straps loose or place them under the child's arm.

! Do not put the shoulder straps behind the children.

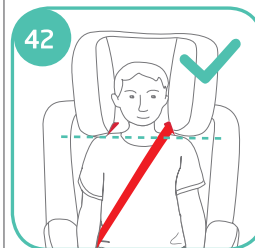

## Group II III 3-point safety belts

! Pass the shoulder strap through the shoulder guide, the belt through the seat slot, and then insert the seat belt buckle into the buckle and tighten the seat belt. **41**

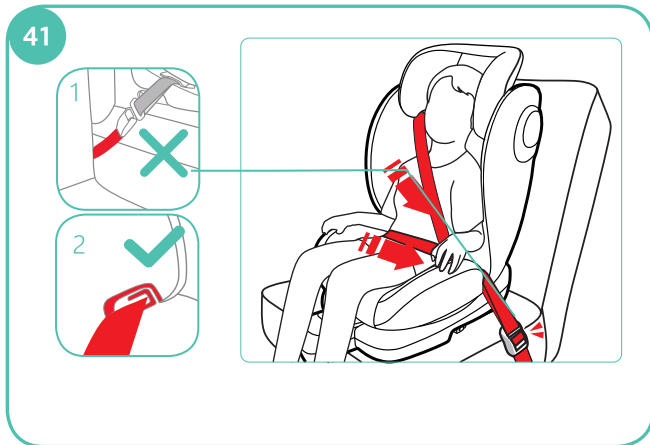

! When used in child mode, the position of the car shoulder strap guide should be the same as or slightly higher than the child's shoulder. **42**

! If the car seat belt buckle is too long, the car seat belt cannot be fastened and cannot be used. **41 -1**

! The car strap must pass through the car strap guide. **41 -2**

! Make sure that both the left and right connectors are fixed to the ISOFIX fixed point and that the indicators on both connectors display green. **41 -3**

! Do not let the straps loose or place them under the child's arm.

! Do not put the shoulder straps behind the children.

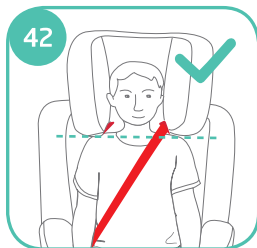

## Detach Clothes Cover

see images **36 - 43**

1. Press the red button to disengage the buckle. (Fig.36)
2. Follow steps (Fig.37-Fig.43)

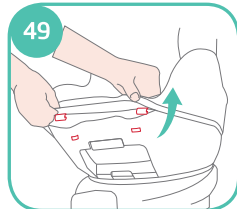
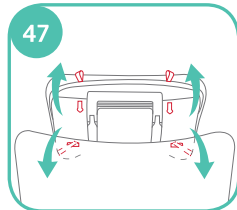
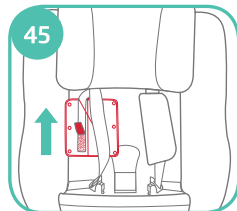
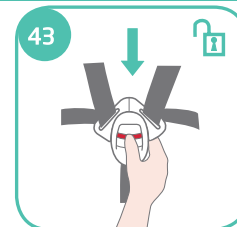
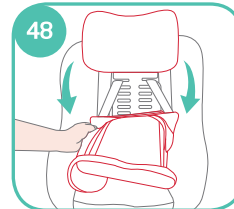
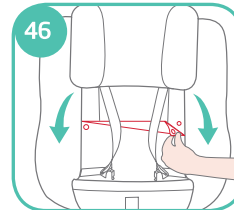
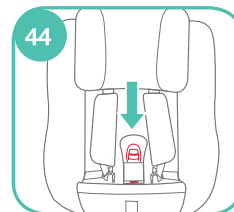

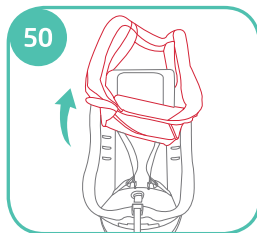

## Maintenance

- ! Please wash the seat cover and inner padding with cold water under.
- ! Do not iron.
- ! Do not bleach or dry clean the soft goods.
- ! Do not use undiluted detergents gasoline or other organic solvent to wash the child restraint or base. It may cause damage to the child restraint.
- ! Do not wring out the seat cover and inner padding to dry. It may leave the seat cover and inner padding with wrinkles.
- ! Please hang dry the seat cover and inner padding in the shade.
- ! Please remove the child restraint and base from the vehicle seat if not in use for a long period of time. Put the child restraint in a cool, dry place where your child cannot access it.







**PANTONE 2035C**

C:0 M:100 Y:100 K:0



**PANTONE 2394C**

C:100 M:20 Y:0 K:0

展开尺寸：200x140mm

成品尺寸：100X140mm